

TYPICAL ASSEMBLIES FIXED AT WALL

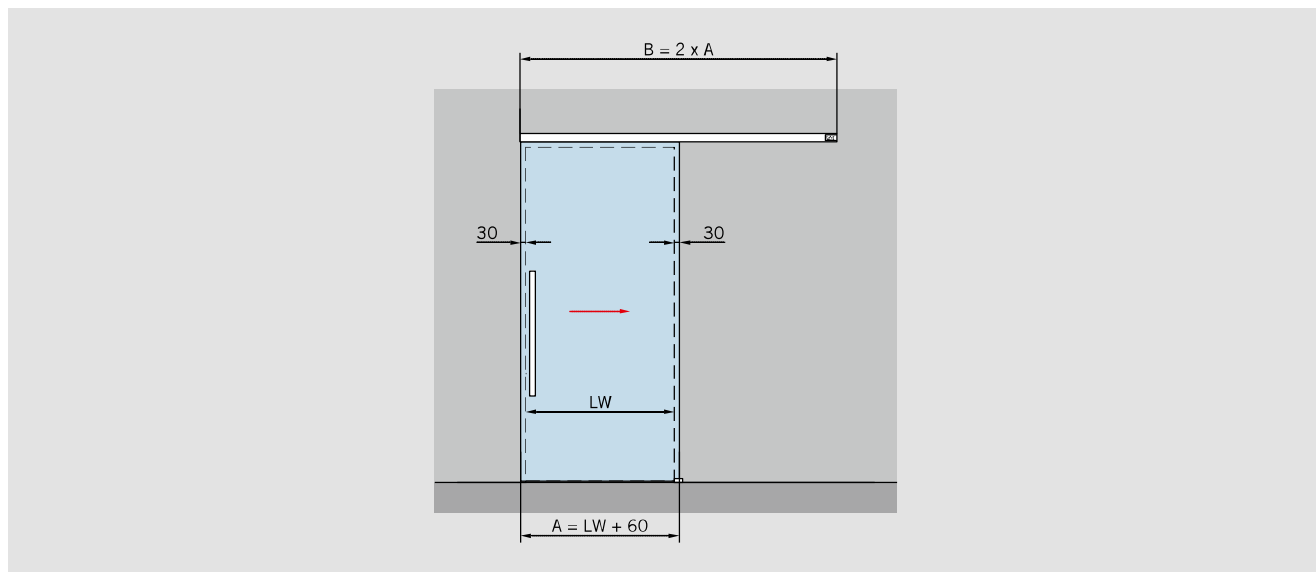

Fixed at wall

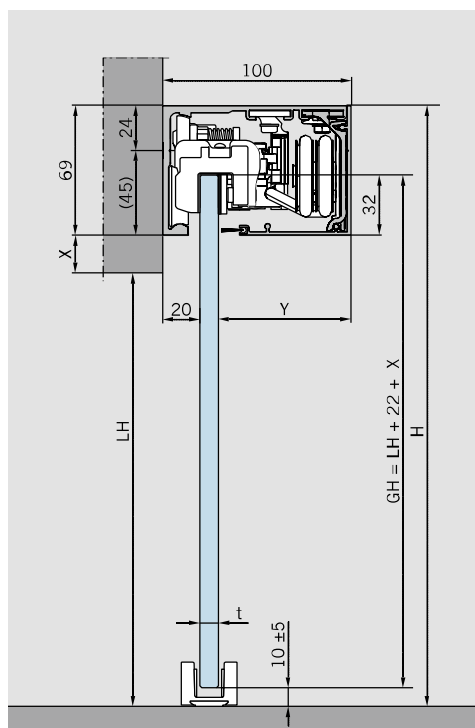

Features and data

For installation with one or two door panels fixed at wall;
for 8 – 13.5 mm glass thickness

Max. weight of door panels

120 kg

Calculation of glass height

$$GH = LH + 22 + X$$

(see drawing)

max. 3000 mm

Calculation of glass width

$$A = LW + 60 \text{ mm}$$

min. 850 mm

max. 1500 mm

max. 2 x 1470 mm

- A = Glass width
- B = Length of track
- GH = Glass height
- H = Total height
- LH = Clear opening height
- LW = Clear opening width
- t = Glass thickness
- Y = 100 - 20 - t

TYPICAL ASSEMBLIES FIXED AT CEILING

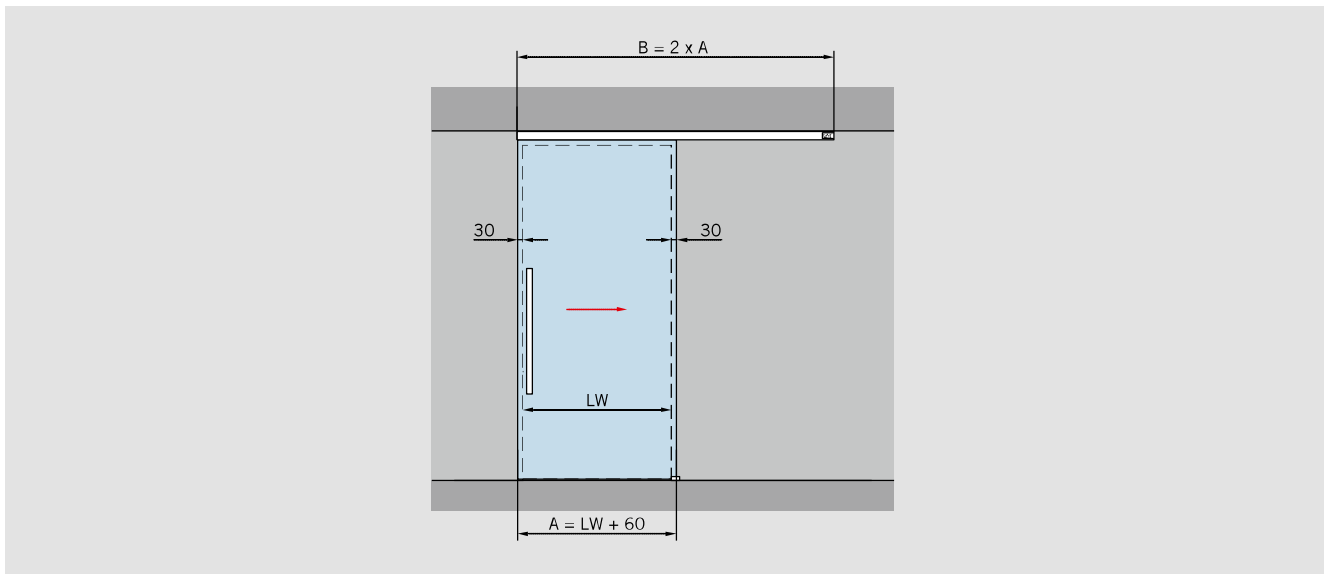

Fixed at ceiling

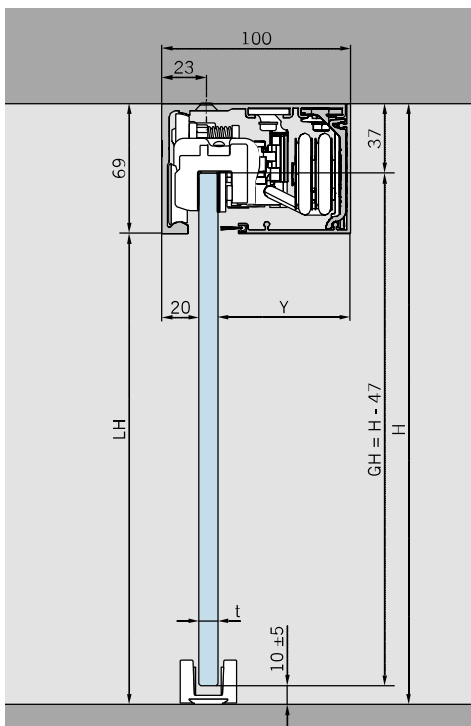

Features and data

For installation with one or two door panels fixed at ceiling;
for 8 – 13.5 mm glass thickness

Max. weight of door panels

120 kg

Calculation of glass height

$$GH = H - 47$$

(see drawing)

max. 3000 mm

Calculation of glass width

$$A = LW + 60 \text{ mm}$$

min. 850 mm

max. 1500 mm

max. 2 x 1470 mm

- A = Glass width
- B = Length of track
- GH = Glass height
- H = Total height
- LH = Clear opening height
- LW = Clear opening width
- t = Glass thickness
- Y = 100 - 20 - t

TYPICAL ASSEMBLIES WITH SIDELIGHT, ON ONE SIDE

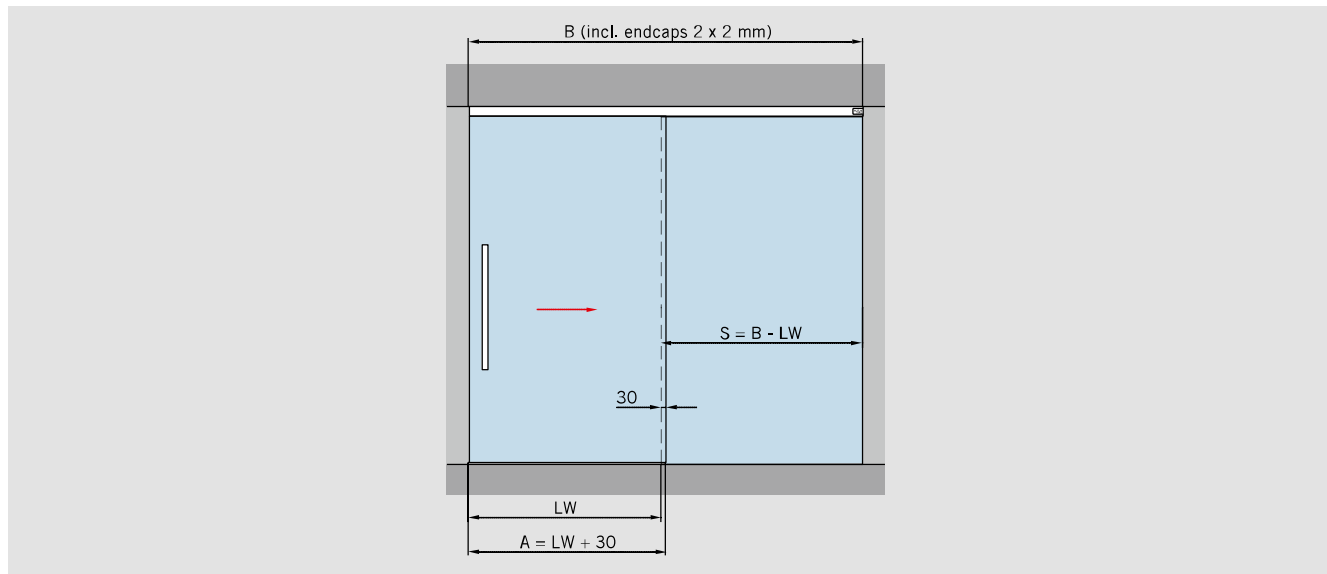

Fixed at ceiling

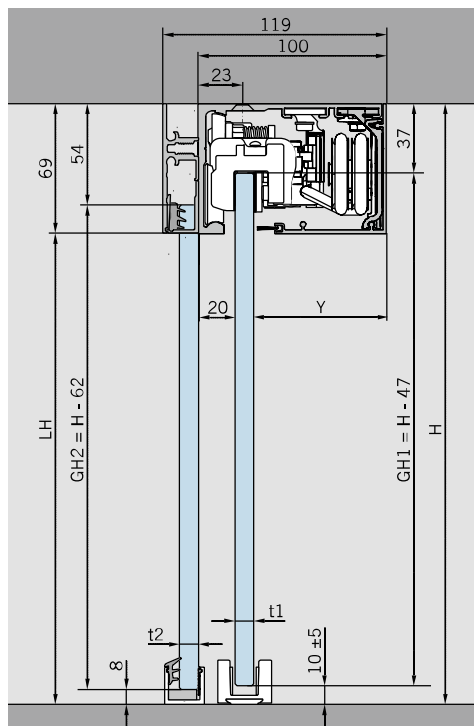

Calculation of glass height

$GH1 = H - 47$
 $GH2 = H - 62$
 max. 3000 mm

Fixed at false ceiling

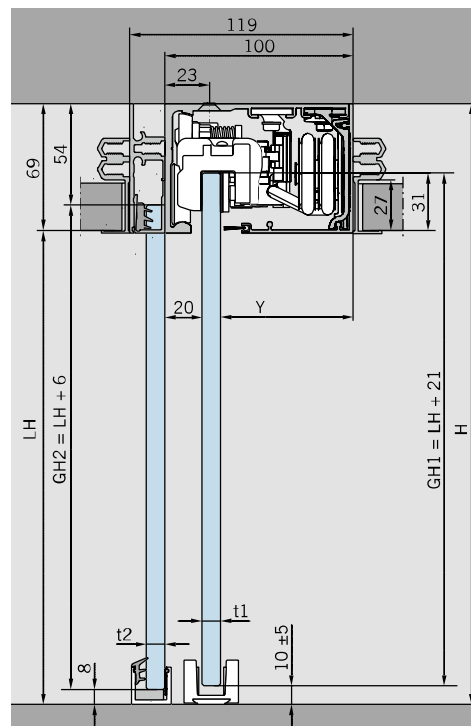

Calculation of glass height

$GH1 = LH + 21$
 $GH2 = LH + 6$
 max. 3000 mm

Features and data

For installation with one door panel with sidelight on one side; for 8 – 13.5 mm glass thickness

Max. weight of door panels

120 kg

Calculation of glass width

$A = LW + 30$ mm

min. 850 mm

max. 1500 mm

A = Glass width
 B = Length of track
 GH1 = Glass height sliding door
 GH2 = Glass height sidelight
 H = Total height

LH = Clear opening height
 LW = Clear opening width
 S = Glass width sidelight
 t1 = Glass thickness sliding door
 t2 = Glass thickness sidelight
 Y = $100 - 20 - t1$

TYPICAL ASSEMBLIES WITH SIDELIGHT, ON BOTH SIDES

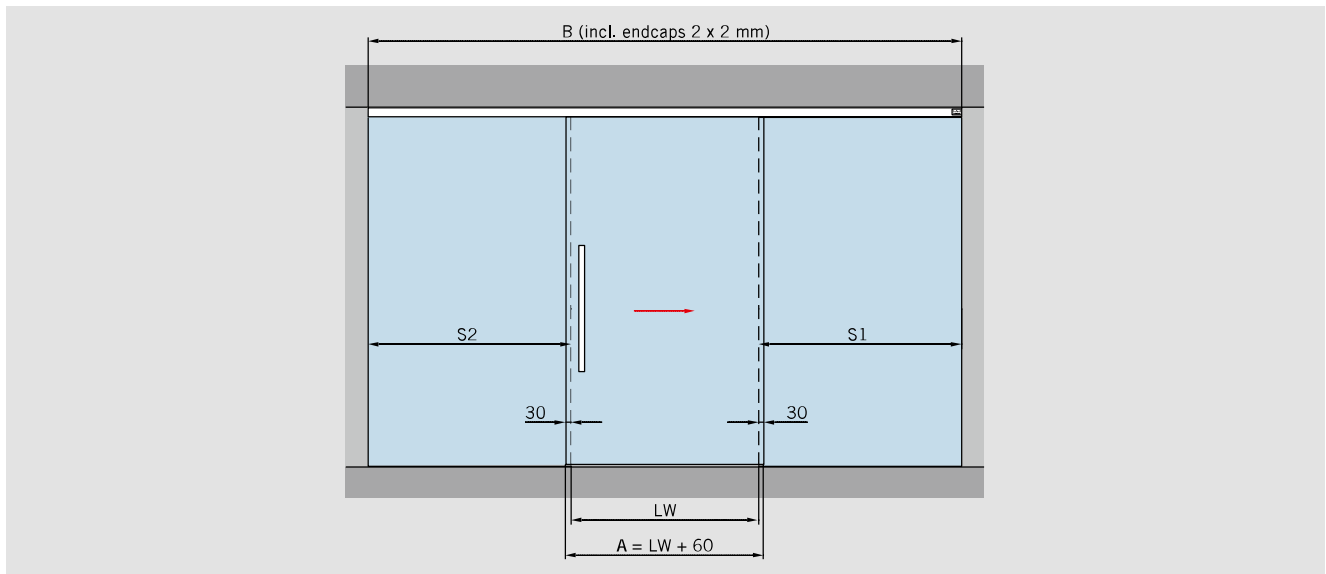

Fixed at ceiling

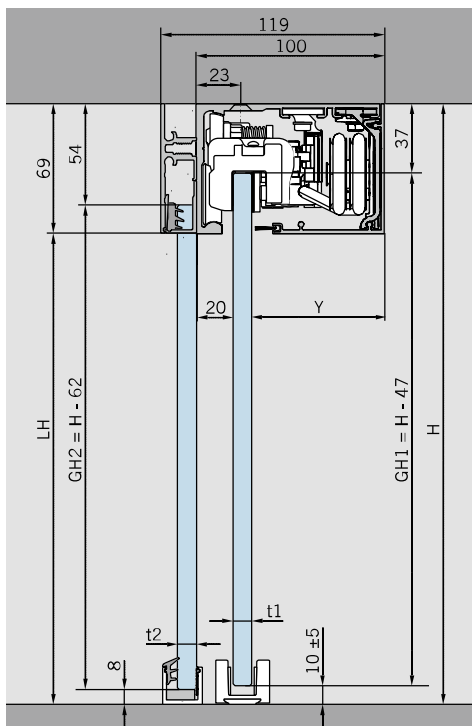

Calculation of glass height

$GH1 = H - 47$
 $GH2 = H - 62$
 max. 3000 mm

Fixed at false ceiling

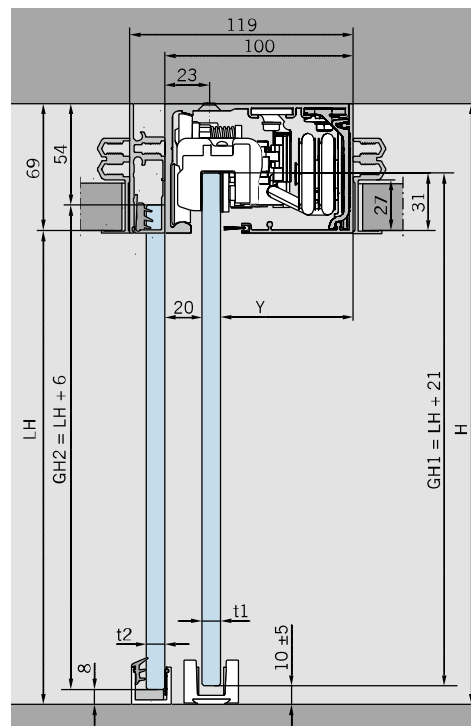

Calculation of glass height

$GH1 = LH + 21$
 $GH2 = LH + 6$
 max. 3000 mm

Features and data

For installation with one door panel with sidelight on one side; for 8 – 13.5 mm glass thickness

Max. weight of door panels

120 kg

Calculation of glass width

$A = LW + 30$ mm

min. 850 mm

max. 1500 mm

A = Glass width
 B = Length of track
 GH1 = Glass height sliding door
 GH2 = Glass height sidelight
 H = Total height

LH = Clear opening height
 LW = Clear opening width
 S = Glass width sidelight
 t1 = Glass thickness sliding door
 t2 = Glass thickness sidelight
 $Y = 100 - 20 - t1$

TYPICAL ASSEMBLIES WITH TWO DOOR PANELS WITH SIDELIGHTS

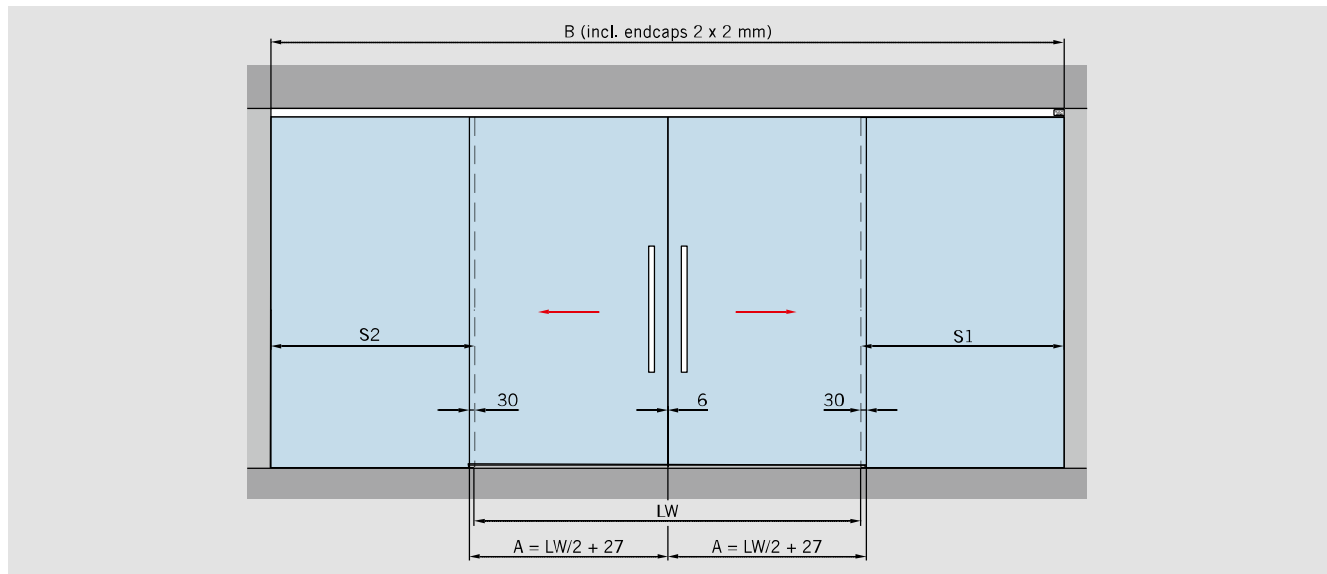

Fixed at ceiling

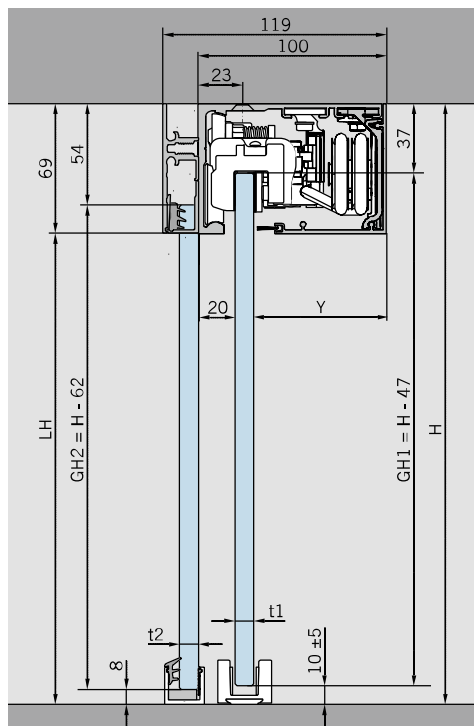

Calculation of glass height

$GH1 = H - 47$
 $GH2 = H - 62$
 max. 3000 mm

Fixed at false ceiling

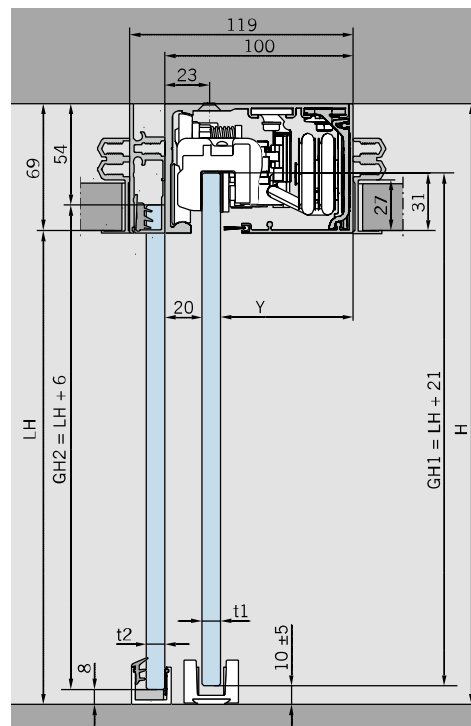

Calculation of glass height

$GH1 = LH + 21$
 $GH2 = LH + 6$
 max. 3000 mm

Features and data

For installation with two door panels with sidelights;
for 8 – 13.5 mm glass thickness

Max. weight of door panels

120 kg

Calculation of glass width

$A = LW / 2 + 27 \text{ mm}$
 min. 2 x 850 mm
 max. 2 x 1470 mm

A = Glass width
 B = Length of track
 GH1 = Glass height sliding door
 GH2 = Glass height sidelight
 H = Total height

LH = Clear opening height
 LW = Clear opening width
 S = Glass width sidelight
 t1 = Glass thickness sliding door
 t2 = Glass thickness sidelight
 Y = 100 - 20 - t1

TYPICAL ASSEMBLIES FOR TIMBER DOOR

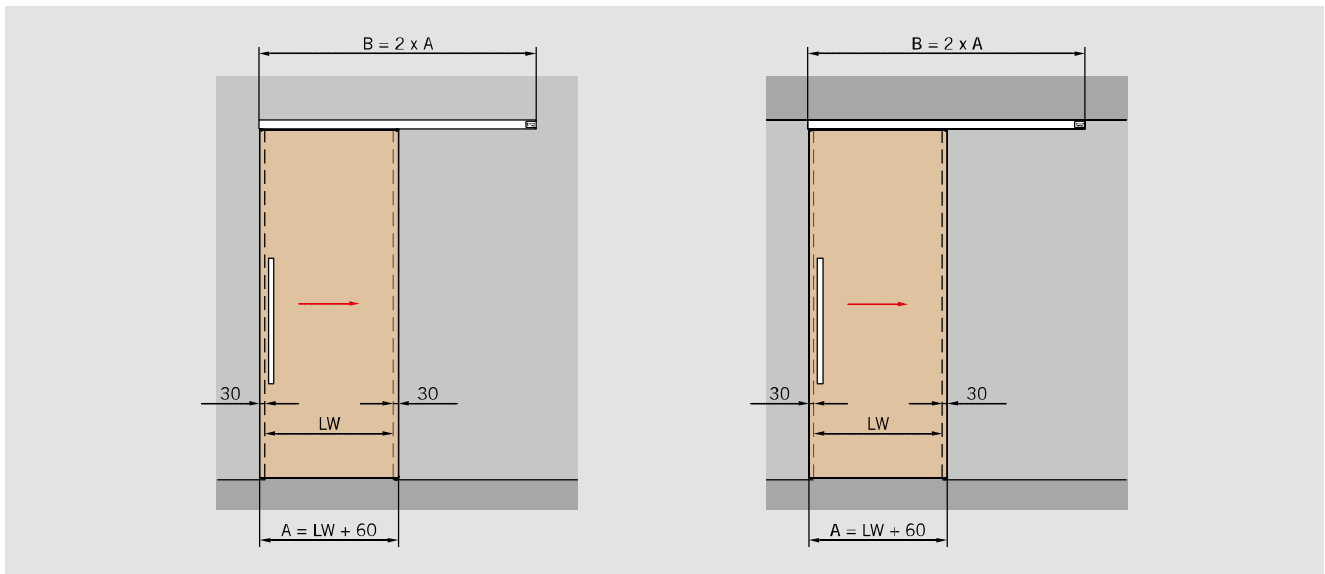

Fixed at wall

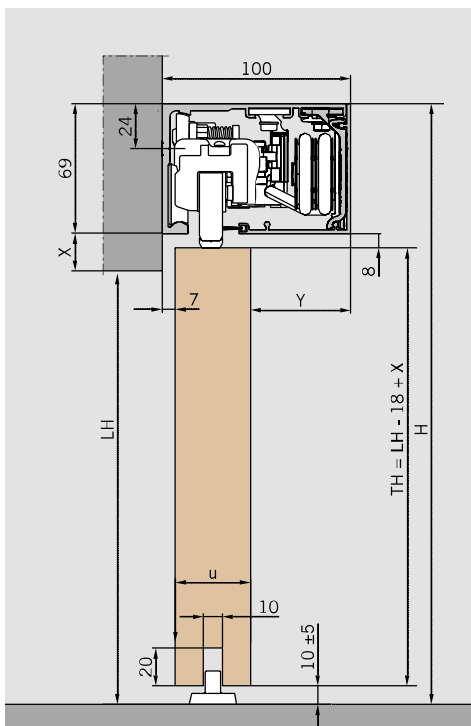

Fixed at ceiling

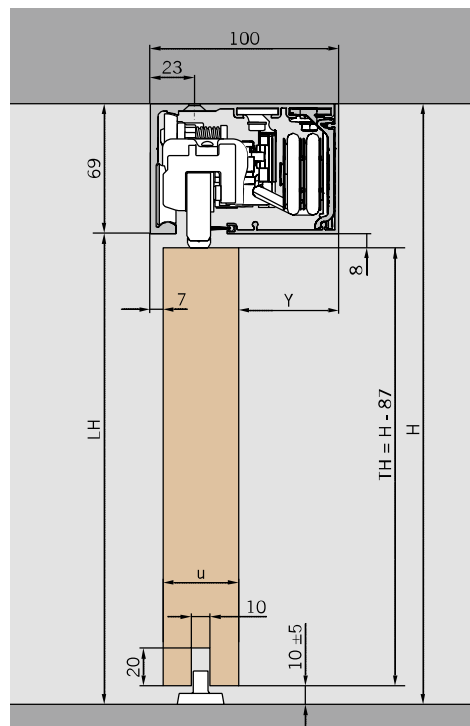

Features and data

For installation with timber doors;
fixed at wall or ceiling,
for 28 – 50 mm timber elements

Max. weight of door panels

120 kg

Calculation of door height

$$TH = LH - 18 + X$$
$$TH = H - 87$$

max. 3000 mm

Calculation of door width

$$A = LW + 60$$

min. 850 mm

max. 1500 mm

max. 2 x 1470 mm

A = Door width
B = Length of track
H = Total height
LH = Clear opening height
LW = Clear opening width
TH = Door height
u = Timber thickness
Y = 100 - 7 - u

TYPICAL ASSEMBLIES FIXED AT GLASS

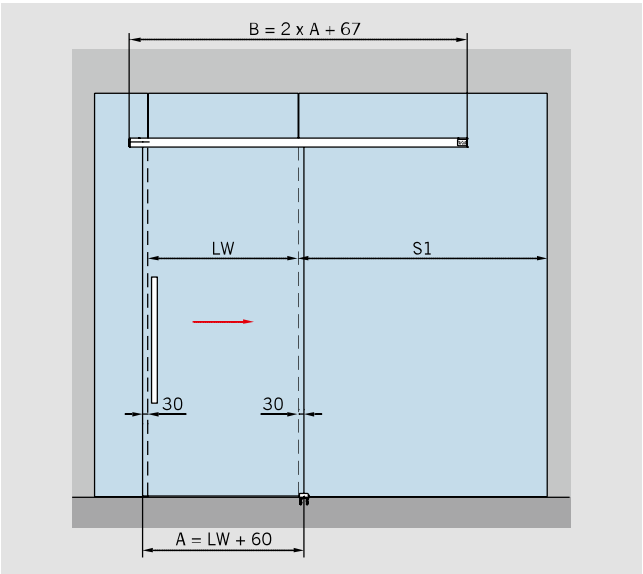

Diagram illustrating the dimensions for a sliding glass assembly. The total width is $B = 2 \times A + 67$. The clear opening width is LW . The distance from the glass edge to the track center is $A = LW + 60$. The track width is $S1$. The distance from the glass edge to the track center is 30 mm.

The total quantity of drillings (AB) depends on clear opening width (LW) and determines the final drilling distance (BA).

Calculation sample:
 $BA = 2 \times (700 - 106) / 4 = 297,0 \text{ mm}$

	T	AB
$600 \leq LW \leq 800$	4	8
$800 < LW \leq 1000$	6	10
$1000 < LW \leq 1200$	8	12
$1200 < LW \leq 1500$	10	14
$1500 < LW \leq 2000$	12	16
$2000 < LW \leq 2500$	14	18

Glass preparation

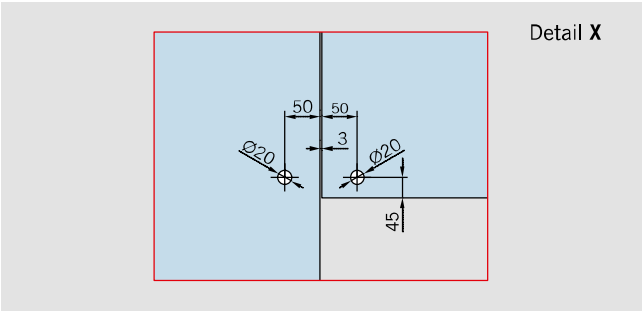

Features and data

For installation with one panel fixed at glass;
for 8 – 13.5 mm glass thickness

Max. weight of door panels

120 kg

Calculation of glass height

$GH = LH + 22$
max. 3000 mm

Calculation of glass width

$A = LW + 60$
min. 850 mm
max. 1500 mm

Fixed at glass

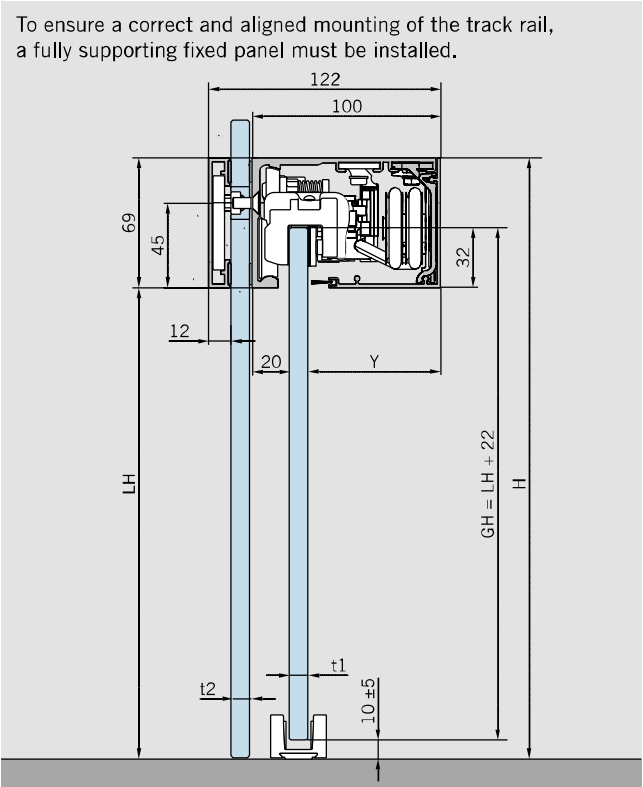

XL Self-Closing	
min. door width	850 mm
min. clear opening width	790 mm
max. door width	1500 mm
max. clear opening width	1440 mm

- A = Glass width
- AB = Quantity of drillings
- B = Length of track
- BA = Drilling distance
- H = Total height
- LH = Clear opening height
- LW = Clear opening width
- GH = Door height
- T = Quantity of drilling distance signed with BA
- t1 = Glass thickness sliding door
- t2 = Glass thickness fixed panel (10 – 19 mm)
- Y = 100 - 20 - t1

TYPICAL ASSEMBLIES WITH TWO DOOR PANELS FIXED AT GLASS

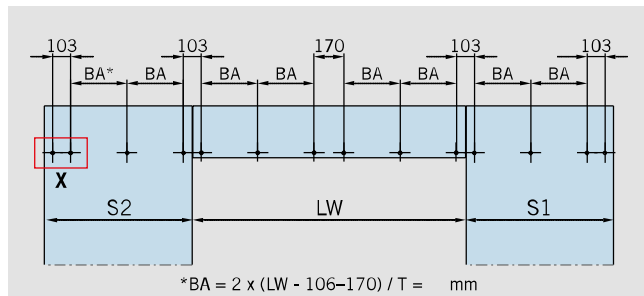
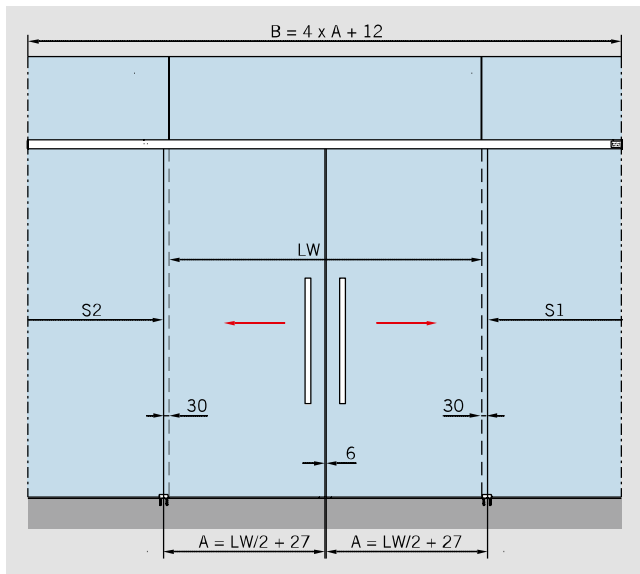

The total quantity of drillings (AB) depends on clear opening width (LW) and determines the final drilling distance (BA).

	T	AB
$1200 < LW \leq 1500$	8	14
$1500 < LW \leq 2000$	12	18
$2000 < LW \leq 2900$	16	22

Calculation sample:

$$BA = 2 \times (1400 - 106 - 170) / 8$$
$$= 281 \text{ mm}$$

Glass preparation

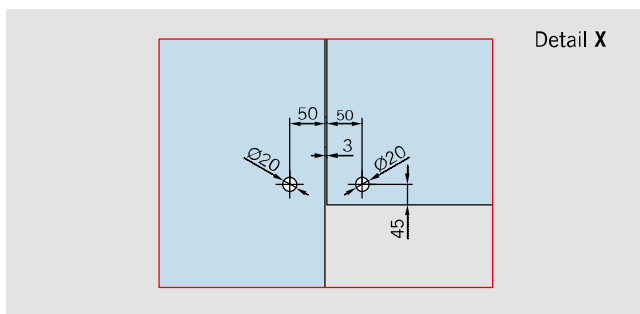

Features and data

For installation with two panel
fixed at glass;
for 8 – 13.5 mm glass thickness

Calculation of glass height

GH = LH + 22
max. 3000 mm

Calculation of glass width

A = LW / 2 + 27
min. 850 mm
max. 2 x 1470 mm

Max. weight of door panels

120 kg

Fixed at glass

To ensure a correct and aligned mounting of the track rail, a fully supporting fixed panel must be installed.

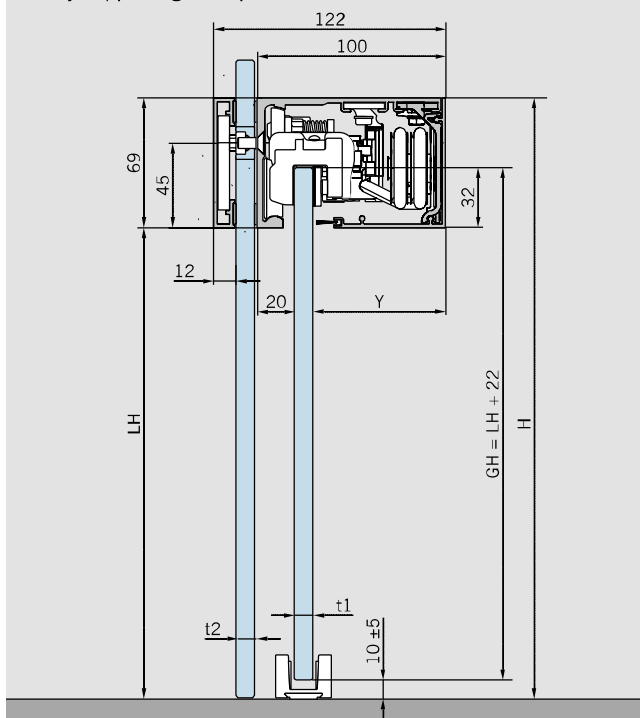

	XL Self-Closing
min. door width without DORMOTION	–
min. clear opening width without DORMOTION	–
min. door width with DORMOTION	850 mm
min. clear opening width with DORMOTION	1646 mm
max. door width	1470 mm
max. clear opening width	2886 mm

A = Glass width
AB = Quantity of drillings
B = Length of track
BA = Drilling distance
H = Total height
LH = Clear opening height
LW = Clear opening width
GH = Door height

T = Quantity of drilling distance signed with BA
t1 = Glass thickness sliding door
t2 = Glass thickness fixed panel (10 – 19 mm)
Y = 100 - 20 - t1

SLIDING DOOR SETS, FOR SELECTED CLEAR OPENING WIDTH

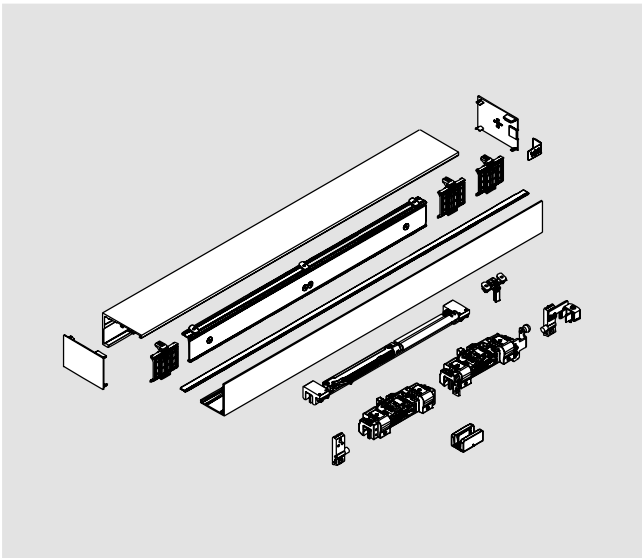

Comfort XL Self-Closing
Set for wall installation with
Self-Closing unit,
incl. DORMOTION, max. 120 kg

Incl. track profile, cover profile
and brushes

Complete accessories for
8 – 13.5 mm glass thickness

	Panel width	Profile length	Art. No.
Right	950	1880	36.600
Left	950	1880	36.601
Right	1250	2480	36.610
Left	1250	2480	36.611
Right	1450	2880	36.602
Left	1450	2880	36.603

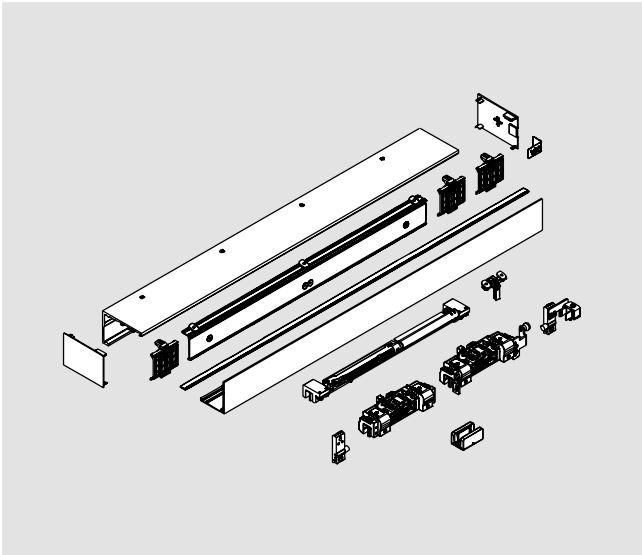

Comfort XL Self-Closing
Set for ceiling installation with
Self-Closing unit,
incl. DORMOTION, max. 120 kg

Incl. track profile, cover profile
and brushes

Complete accessories for
8 – 13.5 mm glass thickness

	Panel width	Profile length	Art. No.
Right	950	1880	36.604
Left	950	1880	36.605
Right	1250	2480	36.612
Left	1250	2480	36.613
Right	1450	2880	36.606
Left	1450	2880	36.607

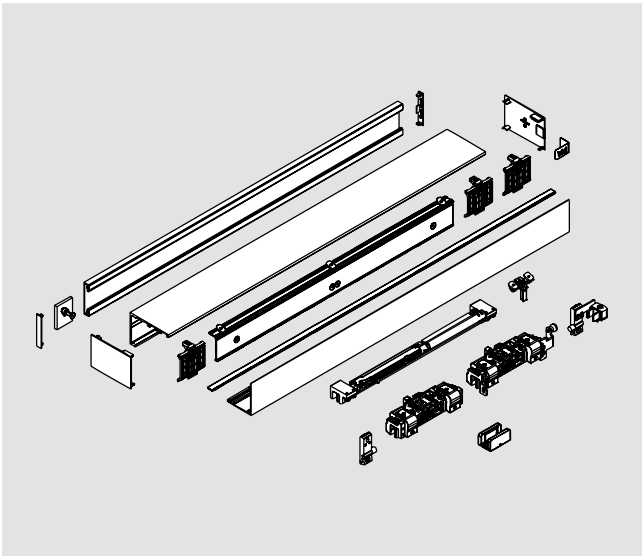

Comfort XL Self-Closing
Set for glass installation with
Self-Closing unit,
incl. DORMOTION, max. 120 kg

Incl. track profile, cover profile,
counter profile and brushes

Complete accessories for
8 – 13.5 mm glass thickness

	Panel width	Profile length	Art. No.
Right	850	1767	36.614
Left	850	1767	36.615
Right	1050	2167	36.616
Left	1050	2167	36.617
Right	1310	2687	36.608
Left	1310	2687	36.609

SLIDING DOOR SETS, FOR INDIVIDUAL CLEAR OPENING WIDTH

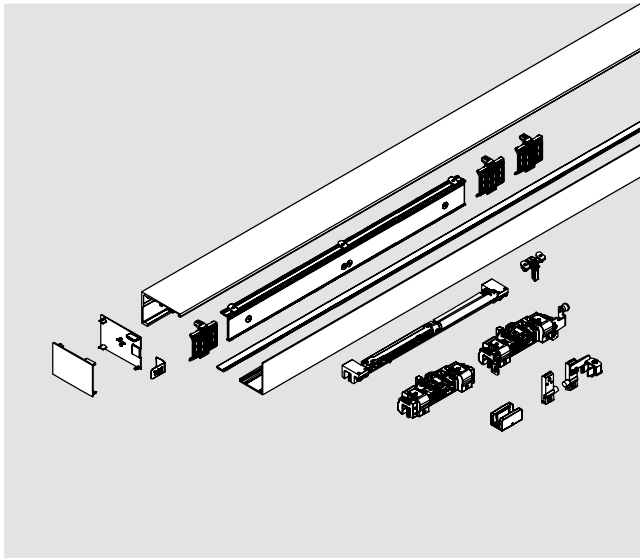
**Comfort XL Self-Closing**

Set for wall installation
with Self-Closing unit,
incl. DORMOTION, max. 120 kg

Right

Art. No. 36.620

Left

Art. No. 36.621

Min. panel width 850 mm,
Profile length xxxx mm*
(max. 2980 mm)
Max. panel width 1500 mm

Incl. track profile, cover profile
and brushes

Complete accessories for
8 – 13,5 mm glass thickness

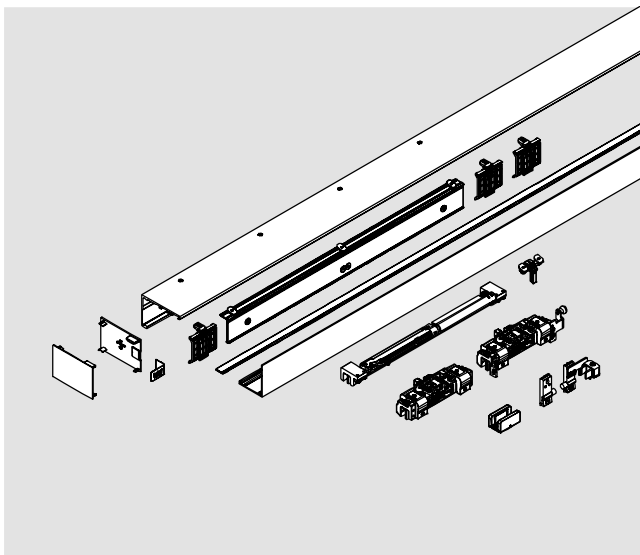
**Comfort XL Self-Closing**

Set for ceiling installation
with Self-Closing unit,
incl. DORMOTION, max. 120 kg

Right

Art. No. 36.622

Left

Art. No. 36.623

Min. panel width 850 mm,
Profile length xxxx mm*
(max. 2980 mm)
Max. panel width 1500 mm

Incl. track profile, cover profile
and brushes

Complete accessories for
8 – 13,5 mm glass thickness

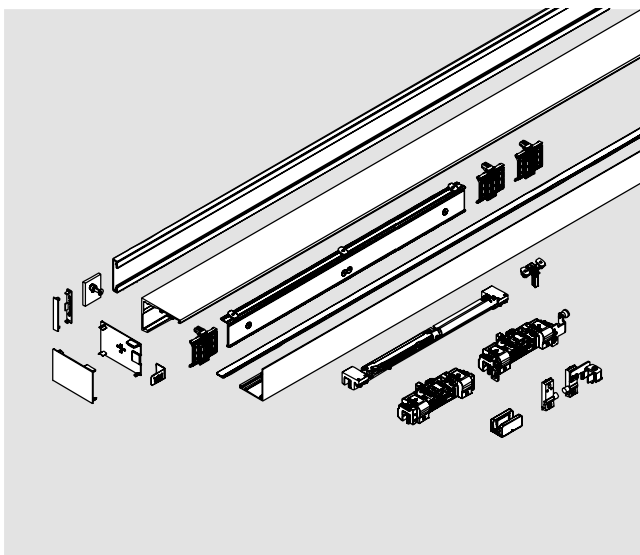
**Comfort XL Self-Closing**

Set for glass installation
with Self-Closing unit,
incl. DORMOTION, max. 120 kg

Right

Art. No. 36.624

Left

Art. No. 36.625

Min. panel width 850 mm,
Profile length xxxx mm*
(max. 2980 mm)
Max. panel width 1500 mm

Incl. track profile, cover profile
and brushes

Complete accessories for
8 – 13,5 mm glass thickness

* to be defined by customer

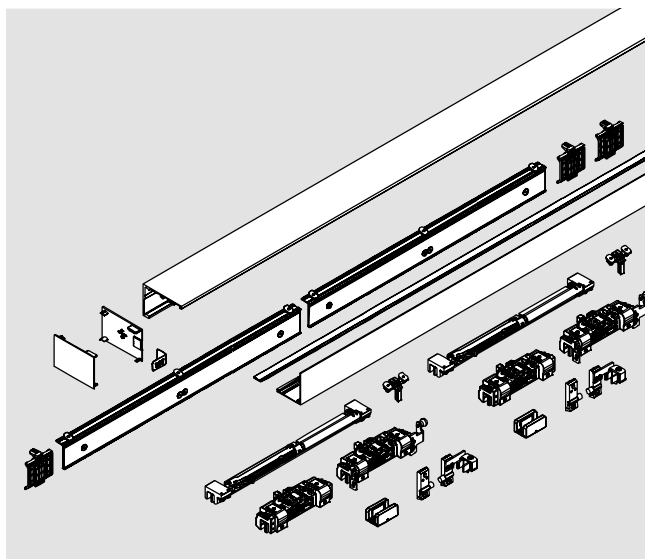

Comfort XL Self-Closing

Art. No. 36.626

Set for 2-panel door,
wall installation, fixed length
incl. DORMOTION, max. 120 kg

Min. panel width 850 mm,
Profile length xxxx mm*
(max. 5900 mm)
Max. panel width 1470 mm

Incl. track profile, cover profile
and brushes

Complete accessories for
8 – 13,5 mm glass thickness

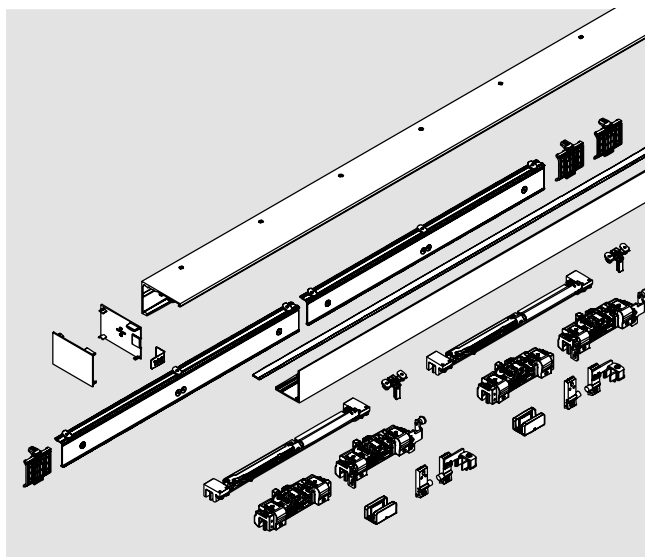

Comfort XL Self-Closing

Art. No. 36.627

Set for 2-panel door,
ceiling installation, fixed length,
incl. DORMOTION, max. 120 kg

Min. panel width 850 mm,
Profile length xxxx mm*
(max. 5900 mm)
Max. panel width 1470 mm

Incl. track profile, cover profile
and brushes

Complete accessories for
8 – 13,5 mm glass thickness

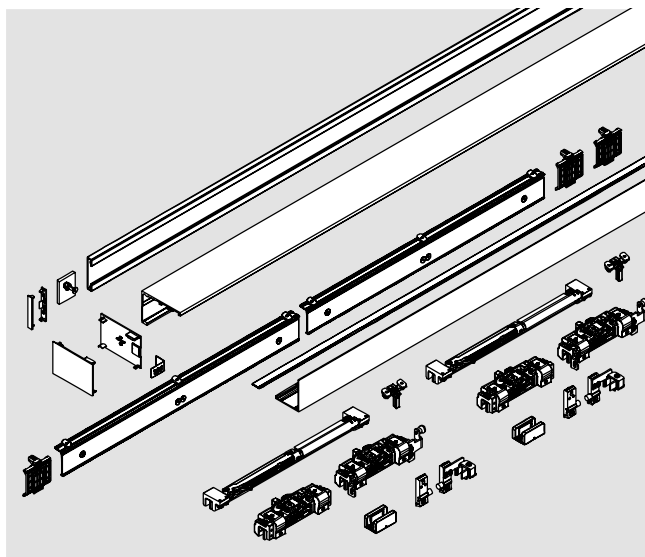

Comfort XL Self-Closing

Art. No. 36.628

Set for 2-panel door,
fixed at glass, fixed length,
incl. DORMOTION, max. 120 kg

Min. panel width 850 mm
(min. LW 1646 mm),
Max. panel width 1470 mm
(max. LW 2886 mm)

Profile length xxxx mm*
(max. 5900 mm)

Incl. track profile, cover profile,
counter profile and brushes

Complete accessories for
8 – 13,5 mm glass thickness

* to be defined by customer

COMPONENT PARTS

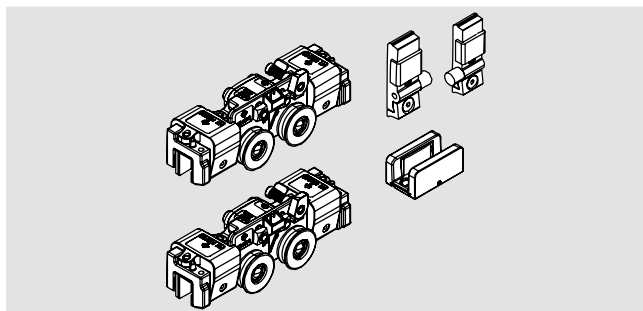

Comfort XL DORMOTION

80 / 150 / Synchro

Accessory set
for DORMOTION variants

Art. No. 36.550

Consisting of: 2 clamp carriers,
2 endstops and 1 floor guide

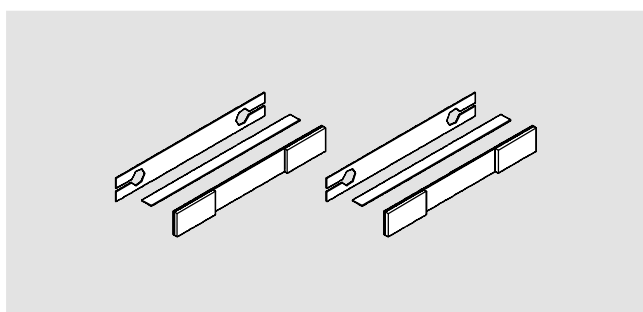

Comfort XL DORMOTION

80 / 150 / Synchro

Gasket set

Art. No. 36.451

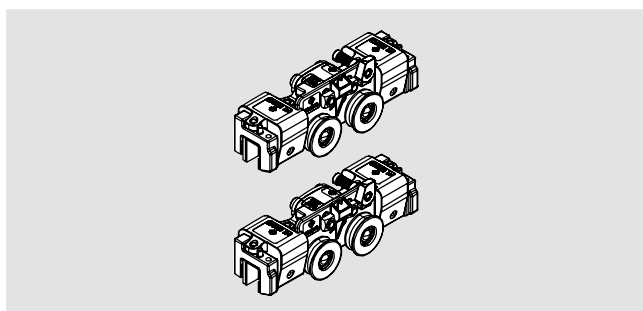

Comfort XL DORMOTION

80 / 150 / Synchro

Pair roller module
for DORMOTION variants

Art. No. 36.551

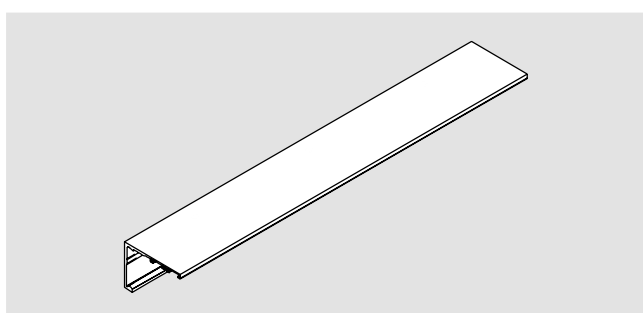

Comfort XL Self-Closing

Track rail for
Self-Closing function
for wall installation

stock length 6000 mm

Art. No. 36.850

fixed length xxxx mm*

Art. No. 36.651

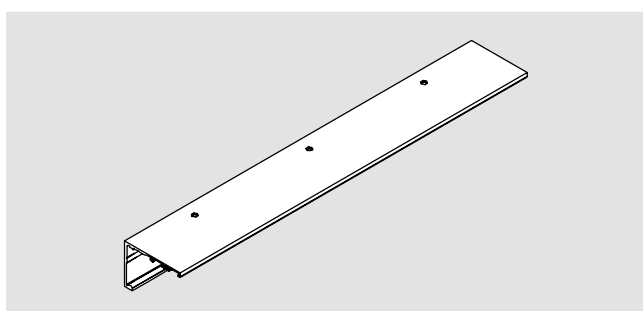

Comfort XL Self-Closing

Track rail for
Self-Closing function
for ceiling installation

stock length 6000 mm

Art. No. 36.852

fixed length xxxx mm*

Art. No. 36.653

* to be defined by customer

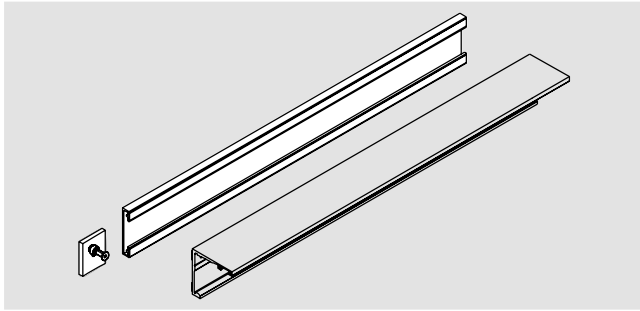

Comfort XL
Counter profile
for installation at glass

stock length 6000 mm

Art. No. 36.xxx (on request)

fixed length xxxx mm*

Art. No. 36.xxx (on request)

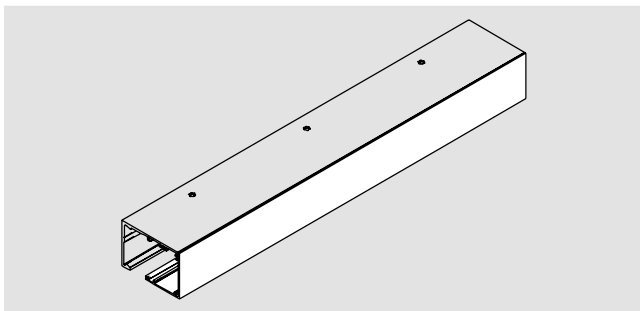

Comfort XL Self-Closing
Cover profile for
Self-Closing function
front cover

stock length 6000 mm

Art. No. 36.854

fixed length xxxx mm*

Art. No. 36.655

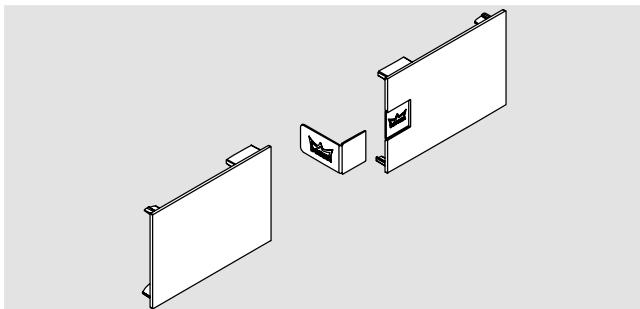

Comfort XL Self-Closing
Set endcaps
for wall and ceiling installation

Art. No. 36.656

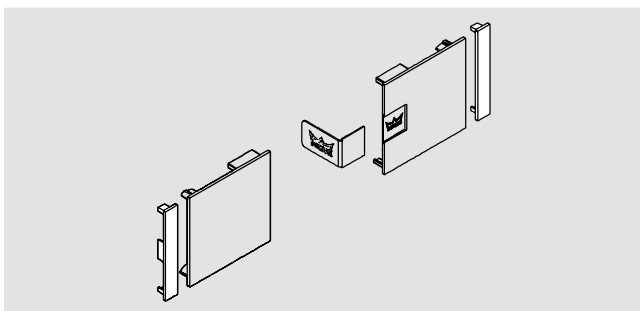

**Comfort XL (DORMOTION
80 / 150 / Synchro)**
Set endcaps
for installation at glass

Art. No. 36.460

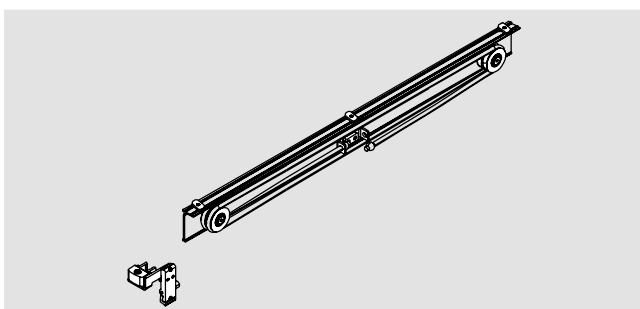

Comfort XL Self-Closing
Flexi-cable unit for
Self-Closing function
With complete accessories

Opening to right side

Art. No. 36.657

Opening to left side

Art. No. 36.658

* to be defined by customer

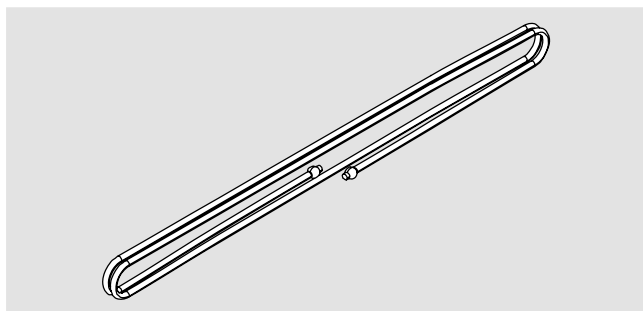

Comfort XL Self-Closing
Flexi-cable for
Self-Closing function

Art. No. 36.659

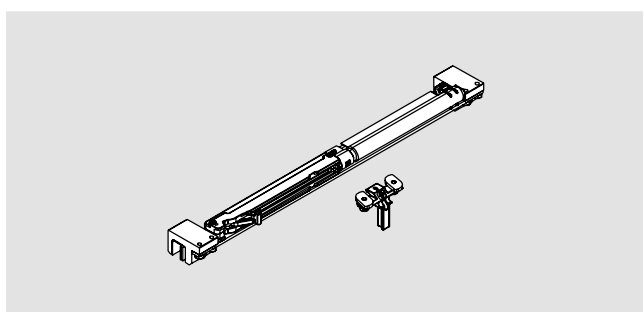

Comfort XL Self-Closing
DORMOTION unit
for Self-Closing function
for max. 120 kg,
with complete accessories

Opening to right side

Art. No. 36.660

Opening to left side

Art. No. 36.661

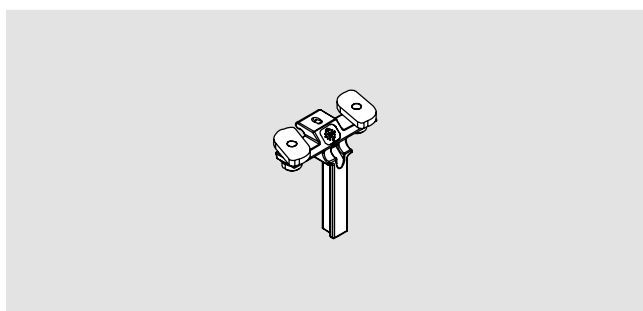

MUTO Comfort
Starter Set
for Self-Closing DORMOTION

Art. No. 36.662

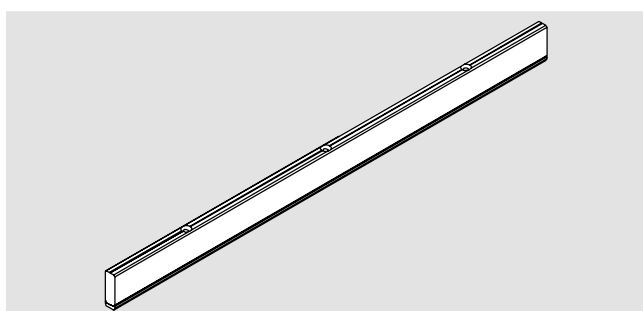

**Comfort XL (DORMOTION
80 / 150 / Synchro)**

Timber adapter set
Profile 12,5 x 36 mm
+ 12,5 x 4 mm,
incl. accessories

1460 mm

Art. No. 36.461

fixed length xxxx mm*,
max. 2500 mm

Art. No. 36.464

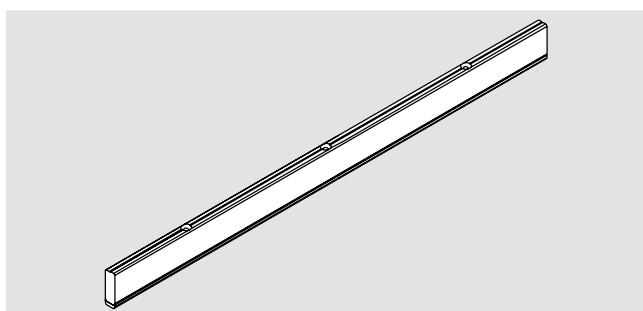

**Comfort XL (DORMOTION
80 / 150 / Synchro)**

Timber adapter profile
Profile 12,5 x 36 mm
+ 12,5 x 4 mm

stock length 6000 mm

Art. No. 36.463

* to be defined by customer

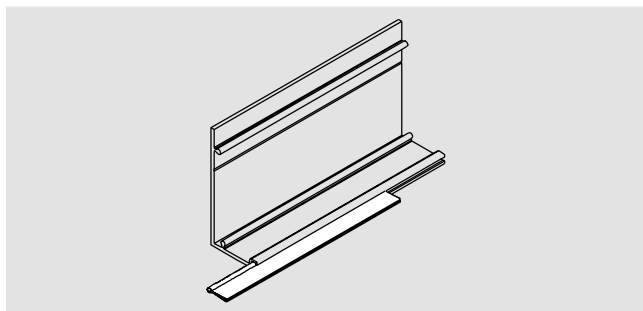

MUTO Comfort
Brush profile
for 8 – 10 mm
and 12 – 13.5 mm glass

Art. No. 36.265

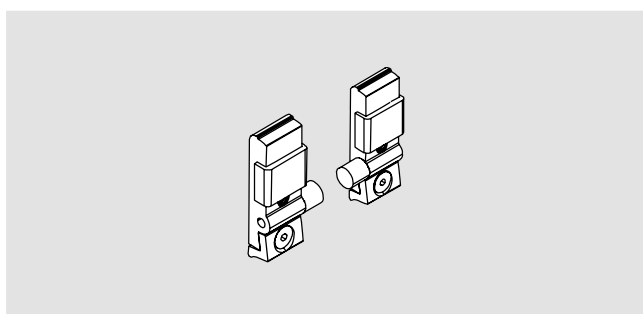

**Comfort XL (DORMOTION
80 / 150 / Synchro)**
Endstop set
2 pieces

Art. No. 36.465

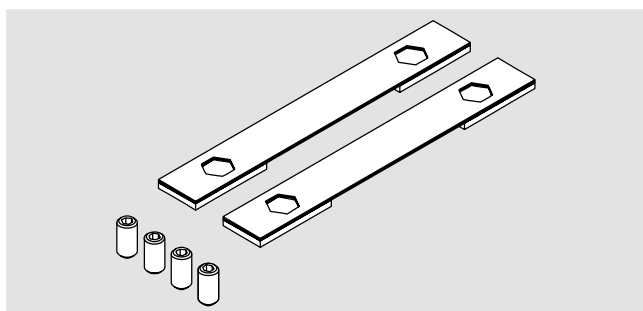

**Comfort XL (DORMOTION
80 / 150 / Synchro)**
LSG set
Accessory set for use with LSG
for one pair of clamp carrier

Art. No. 36.468

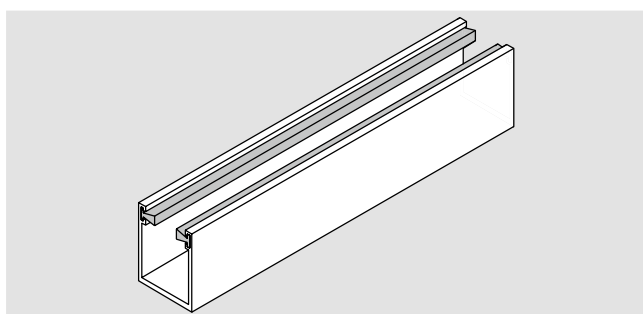

MUTO Comfort
Subsurface floor guide track rail
with brushes

stock length 6000 mm

Art. No. 36.561

fixed length xxxx mm*

Art. No. 36.562

* to be defined by customer

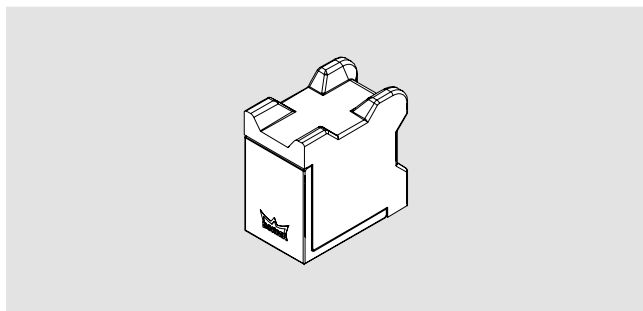
**MUTO Floorstop**

Individually applicable for all options
(glass or timber elements)

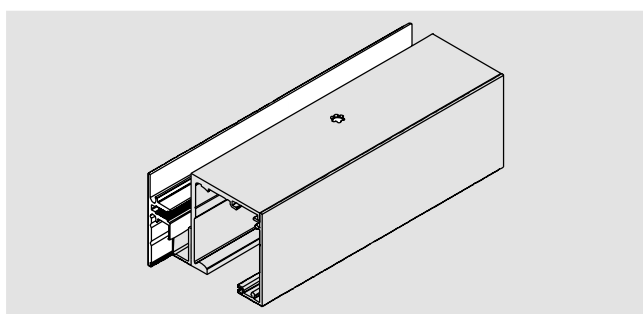
Art. No. 36.851**Comfort XL (DORMOTION 80 / 150 / Synchro)**

Side panel profile
for glass connection on top,
69 mm height,
complete with all gaskets,
Profile for 8 – 13,5 mm glass

stock length 6000 mm

Art. No. 36.469

fixed length xxxx mm*

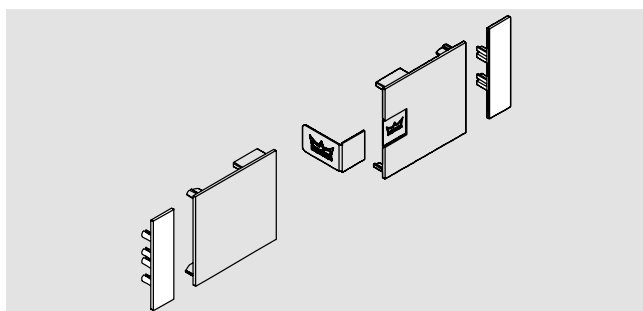
Art. No. 36.474**Comfort XL (DORMOTION 80 / 150 / Synchro)**

Set endcaps
for side panel profile,
69 mm height

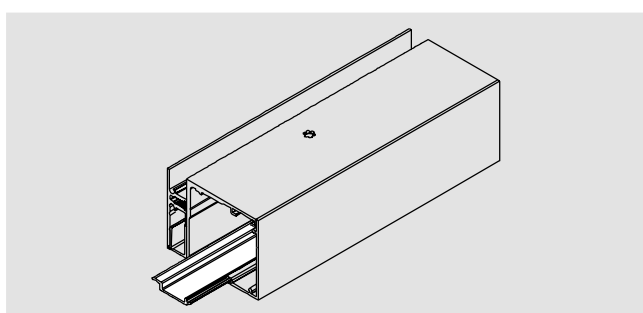
Art. No. 36.471**MUTO Comfort**

View protection profile
for side panel profile,
58 mm + 69 mm height

stock length 6000 mm

Art. No. 36.800

fixed length xxxx mm*

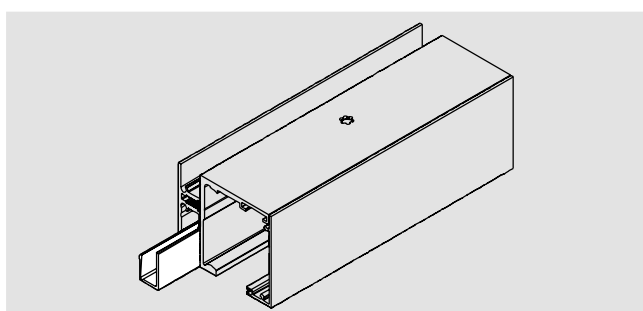
Art. No. 36.801**MUTO Comfort**

Filling profile
for side panel profile,
58 mm + 69 mm height

stock length 6000 mm

Art. No. 36.802

fixed length xxxx mm*

Art. No. 36.803

* to be defined by customer

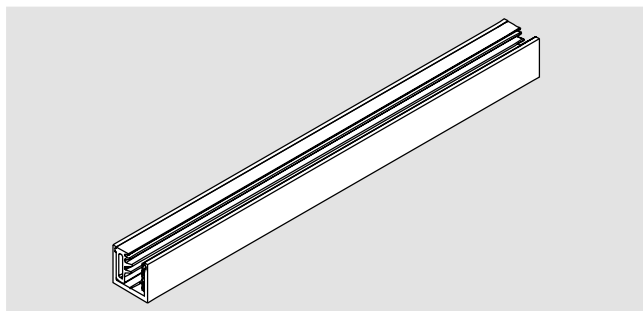

MUTO Comfort

Floor profile
for side panel fixing,
complete with all gaskets,
Profile for 8 – 13.5 mm glass

stock length 6000 mm

Art. No. 36.810

fixed length xxxx mm*

Art. No. 36.811

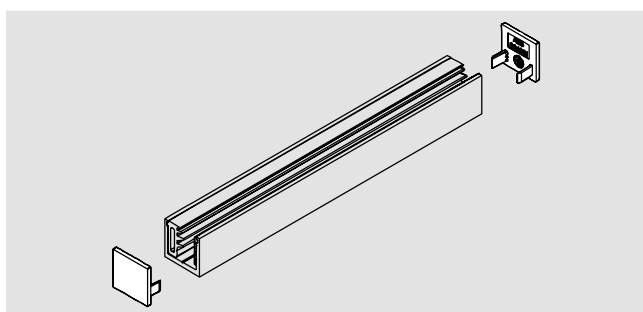

MUTO Comfort

Set endcaps
for floor profile - side panel
fixing

Art. No. 36.812

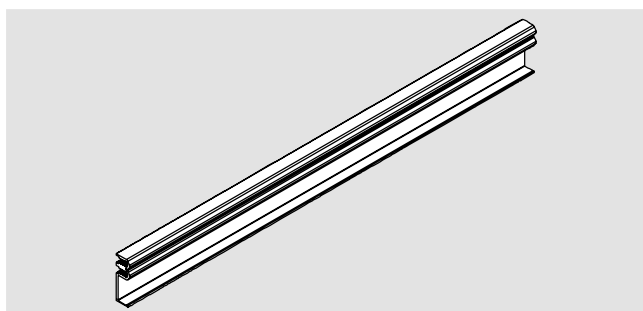

MUTO Comfort

Connecting profile
for false ceilings,
incl. accessory set, applicable
for MUTO Comfort Systems:
80, 150, Telescopic, Synchro

stock length 6000 mm

Art. No. 36.821

fixed length xxxx mm*

Art. No. 36.820

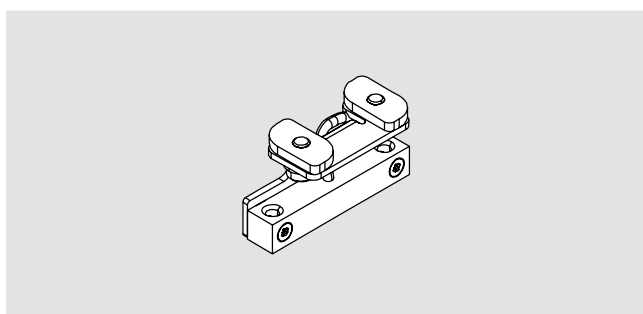

MUTO Comfort

Status-Indicator set
With complete accessory
(Sensor, cable etc.)

Art. No. 36.840

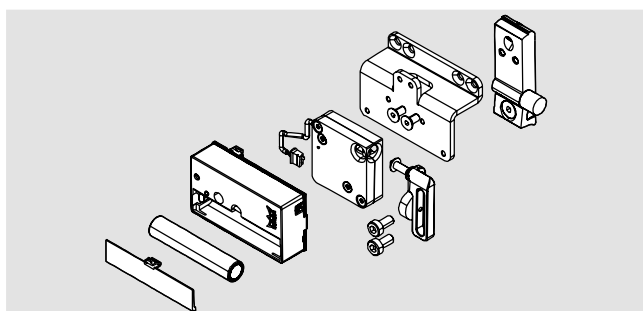

MUTO Comfort

Set locking device complete
With complete accessory:
Locking-mechanic, electronic,
installation-base etc.

Art. No. 36.842

(only in combination
with DORMOTION)

* to be defined by customer

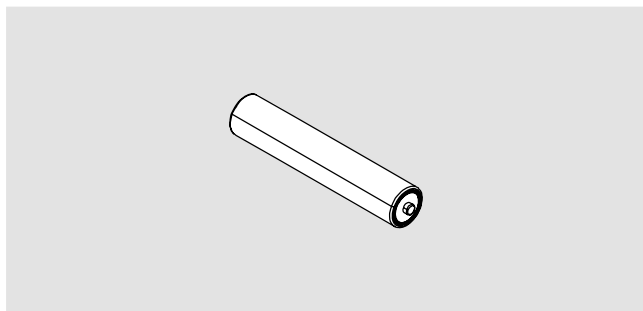

MUTO Comfort
Battery
for locking device

Art. No. 36.845

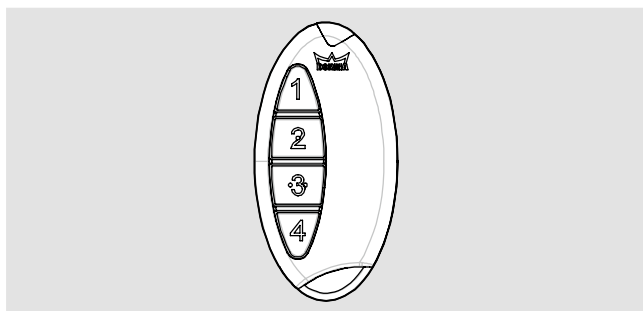

MUTO
Locking device
Portable radio remote control

Art. No. 36.848

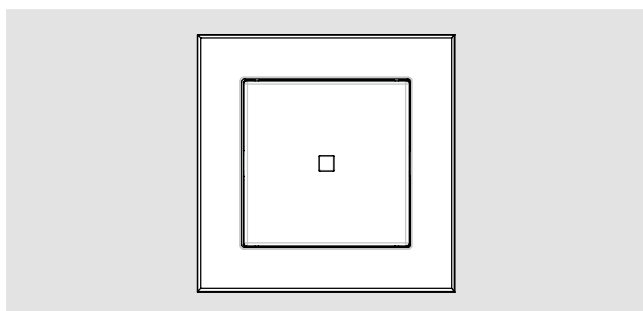

MUTO
Locking device
Wall switch incl. radio remote
control

Art. No. 36.849

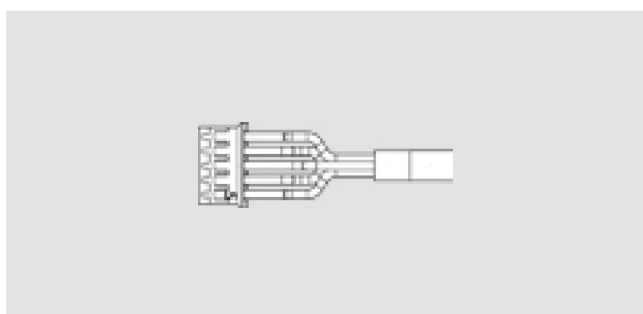

MUTO
Locking device
Single cable set for indicator
and low battery warning

Art. No. 36.855